

SITE PLAN SHOWING IN SY NO: ; AREA: AC 81-03 GTS,  
SITUATED AT DUBBACHERLA(V),MAHESHWARAM (M), RANGA REDDY(DT).

Vensai Venture

Vensai Venture

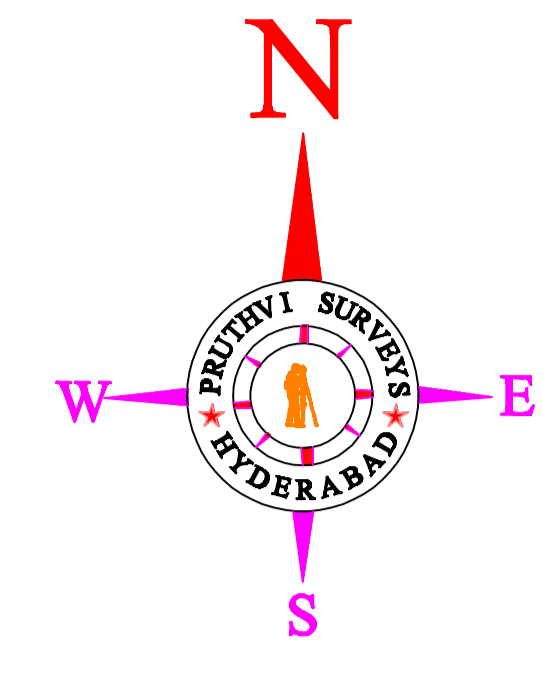
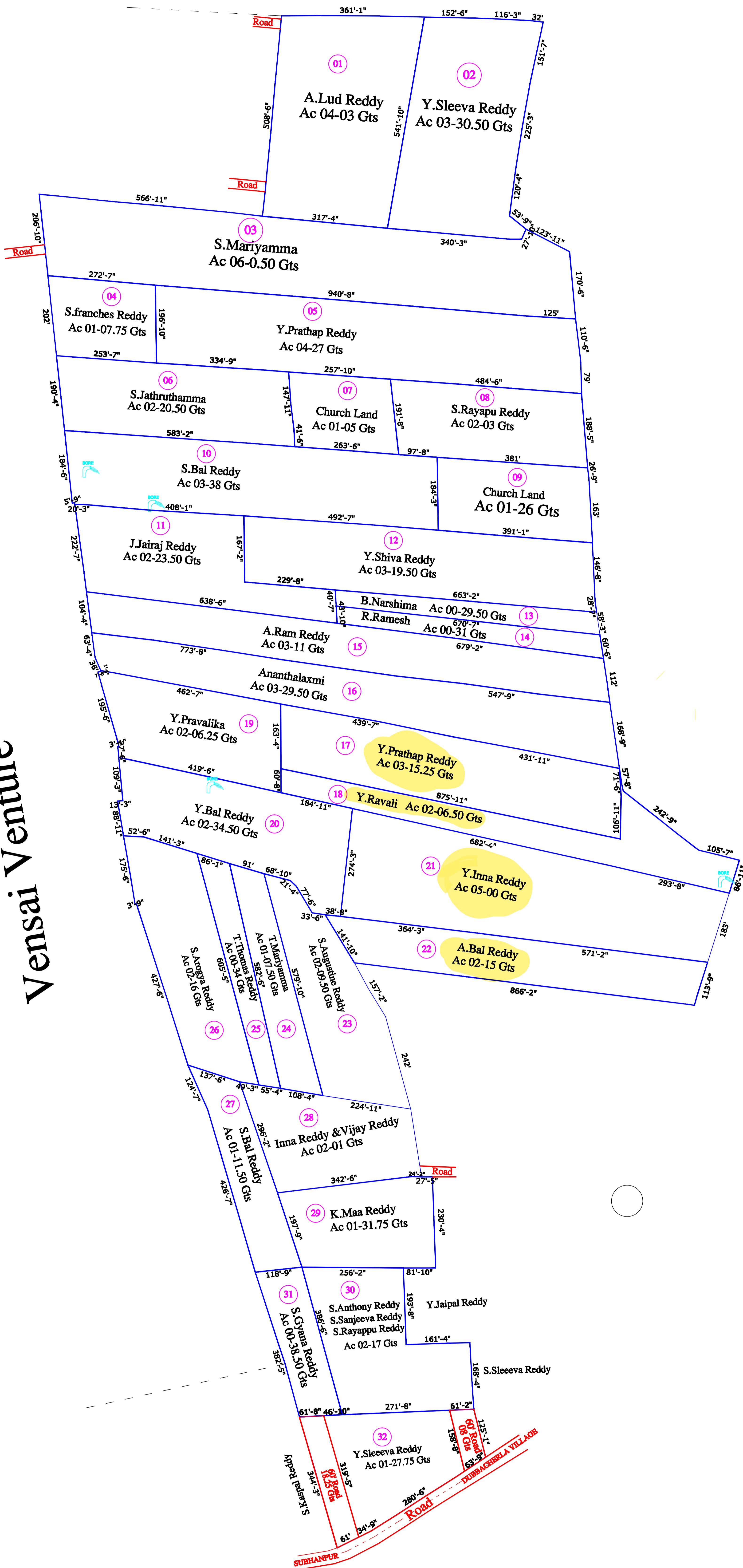

ALL DIMENTIONS ARE IN FEETS

Dt:10-06-2023

S.NO	NAME	EXTENT(Ac- Gts)
01	LUD REDDY	04-03
02	Y.SLEEVA REDDY	03-30.50
03	S.MARIYAMMA	06-0.50
04	S.FRANCHES REDDY	01-07.75
05	Y.PRATHAP REDDY	04-27
06	S.JATHRUTHAMMA	02-20.50
07	CHURCH LAND	01-05
08	S.RAYAPU REDDY	02-03
09	CHURCH LAND	01-26
10	S.BAL REDDY	03-38
11	J.JAIRAJ REDDY	02-23.50
12	Y.SHIVA REDDY	03-19.50
13	B.NARASHIMA	00-29.50
14	R.RAMESH	00-31
15	A.RAM REDDY	03-11
16	ANANTHALAXMI	03-29.50
17	Y.PRATHAP REDDY	03-15.25
18	Y.RAVALI	02-06.50
19	Y.PRAVALIKA	02-06.25
20	Y.BAL REDDY	02-34.50
21	Y.INNA REDDY	05-00
22	Y.BAL REDDY	02-15
23	S.AUGUSTINE REDDY	02-09.50
24	T.MARIYAMMA	01-07.50
25	T.THOMAS REDDY	00-34
26	S.AROGYA REDDY	02-16
27	S.BAL REDDY	01-11.50
28	INNA REDDY & VIJAY REDDY	02-01
29	K.MAA REDDY	01-31.75
30	ANTHONY,SANJEEVA & RAYAPPU REDDY	02-17
31	S.GYANA REDDY	00-38.50
32	Y.SLEEVA REDDY	02-14
<b>TOTAL LAND EXTENT =AC 81-03 GTS</b>		

SURVEYED BY:- E.Venkat Reddy

**Pruthvi Surveys**

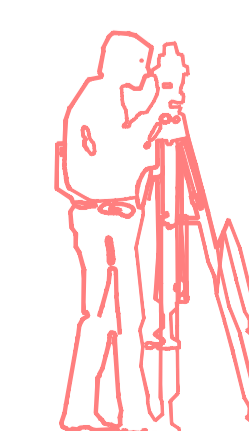

H No 4-156, IInd Floor,  
Gandimaisamma X Road,  
Opp. Priyadarshini Hotel,  
HDFC (ATM) Complex,  
Hyderabad-43, Telangana.

mail: pruthvisurveys2288@gmail.com

Ph.No: 8008081818, 9866142288